

## 15.00 METER CREW TRANSPORT / UTILITY

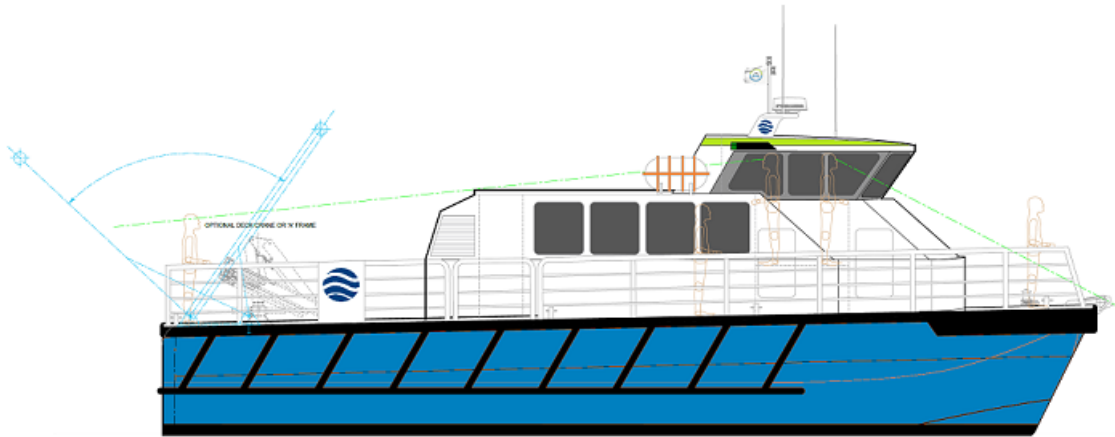

### PRINCIPLE DIMENSIONS:

Length Overall (Hull)	15.400	meters
Length (Hull Moulded)	15.000	meters
Length at Waterline	13.900	meters
Beam (Overall)	5.400	meters
Beam (Hull Moulded)	1.642	meters
Hull Draft (Moulded - Light Ship)	0.900	meters
Hull Draft (Propellers)	1.450	meters
Depth (Moulded)	2.720	meters
Distance between Hulls Centreline	4.258	meters
Freeboard	1.550	meters

### PAYLOAD & CAPACITIES:

Passengers	21	
Crew	3	
Fuel	3000	litres
Water	500	litres
Sullage	250	litres

### PROPULSION:

Main Engines (Type)	2 x 400 HP Inboard Diesel Engines
Propulsion	Fixed Pitch Propellers

### DESIGNER & CLASS:

Designer	Mark Ellis Marine Design
Indian Register of Shipping (IR Class)	Drawings Construction (Optional Extra)

### PERFORMANCE:

Speed	100% Loaded	22	Knots (100% MCR)
	100% Loaded	20	Knots (80%~85% MCR)



# COMMUTER CRAFT

[www.commuter-craft.com](http://www.commuter-craft.com)  
[sales@commuter-craft.com](mailto:sales@commuter-craft.com)

# 15.00 METER CREW TRANSPORT / UTILITY

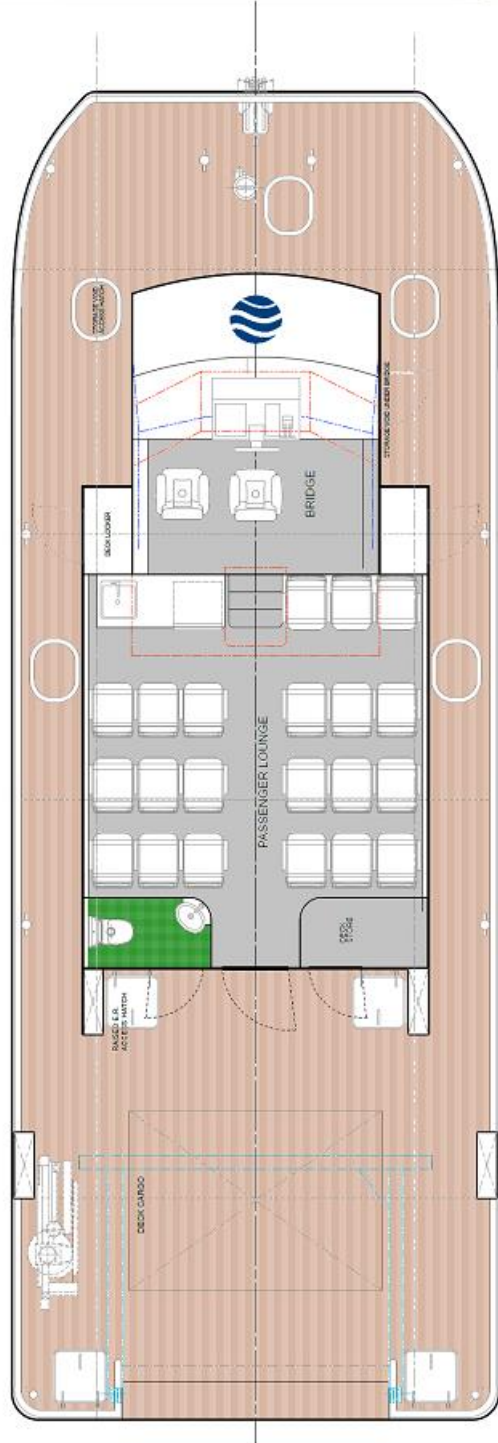
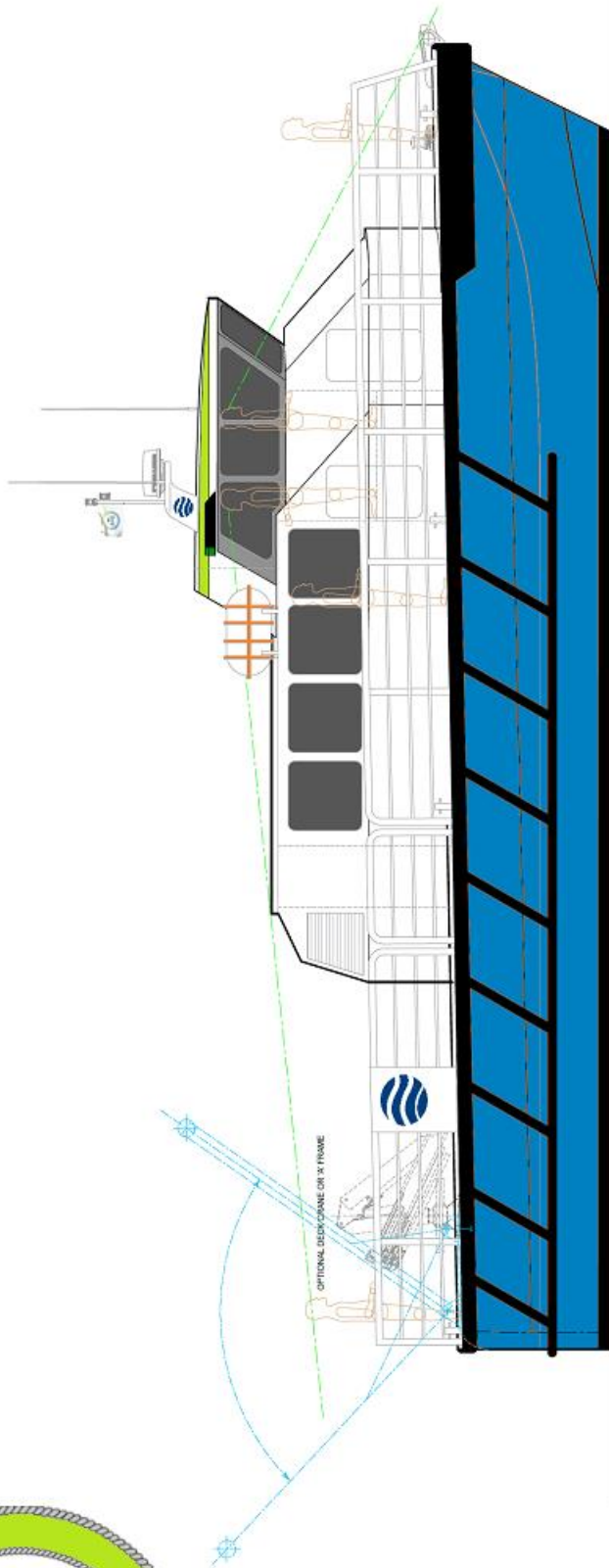

# COMMUTER CRAFT

[www.commuter-craft.com](http://www.commuter-craft.com)  
[sales@commuter-craft.com](mailto:sales@commuter-craft.com)